



Motion Sensor

If the Motion Status continually shows “STOPPED” and there are no sensors installed, do the following:

1. While the unit is operating, remove the Terminal Block “TB-1” completely, wait a few seconds and replace. (This is the large 24-pin connector located on the Interface Board.) This should reset the sensor circuits.

If this should fail, then check the following:

2. With sensors removed, test that TB-1 pins # 5, 6, 8, 10, 11, 13, 15, 16 & 18 are shorted together. (Pins 6, 11, & 16 are signal grounded.)

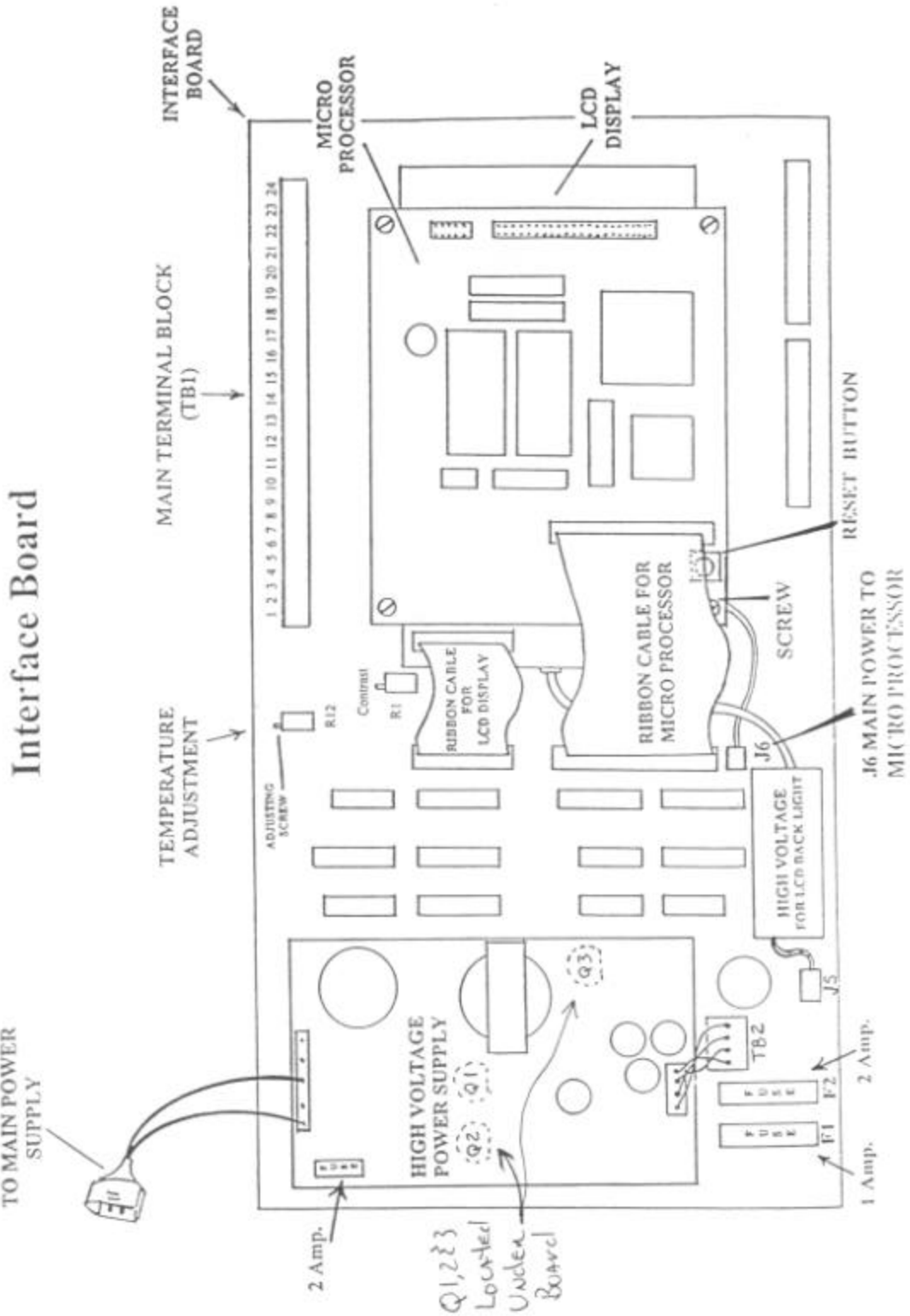

Innovative Design, Engineering and Manufacturing since 1946

4420 San Fernando Road Glendale CA 91204 818 247 7500 fax 818 247 7257 melco@melcowire.com www.melcowire.com



CEC-3
Terminal Block – 1
TB-1
(24 Pin Connector)

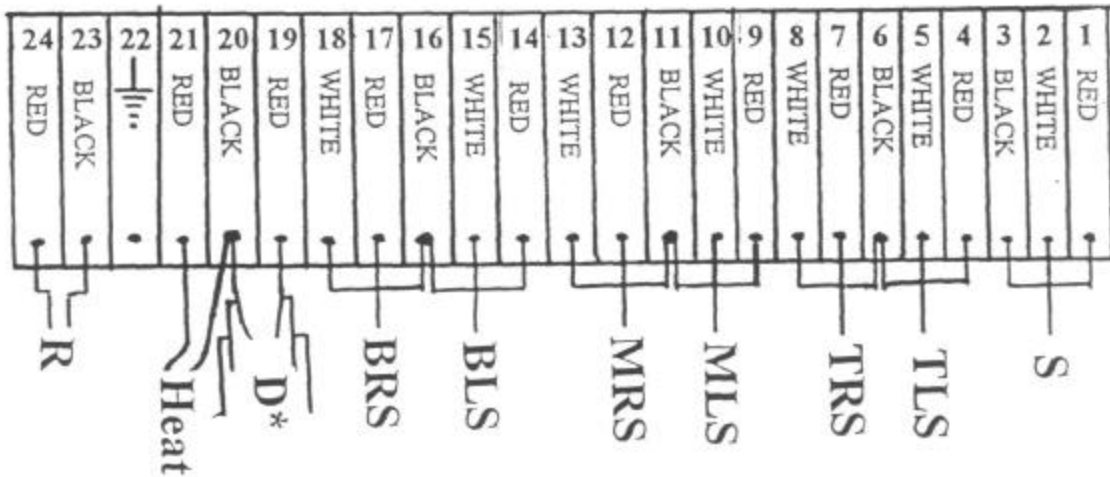

- S** = Temperature Sensor
- TLS** = Top Left Motion Sensor
- TRS** = Top Right Motion Sensor
- MLS** = Middle Left Motion Sensor
- MRS** = Middle Right Motion Sensor
- BLS** = Bottom Left Motion Sensor
- BRS** = Bottom Right Motion Sensor
- D*** = Door Alarm
- Heat** = Heater
- R** = Relay

12 Wires Total (10 Connections)

* Serial Connection, the three levels are connected in serial, as one circuit.